

Version 01-2021



SNOWRIDER

RIDE THE WILD

User manual

SNOWRIDER kit

Models:

SR120 WENDIGO

SR127 WENDIGO

SR137 WENDIGO



Tyumen, Russia
2021

Registering your SNOWRIDER kit

Each SNOWRIDER kit has important id. Serial number. The serial number can be found on the front frame part on left side between subframe fixation bolts.

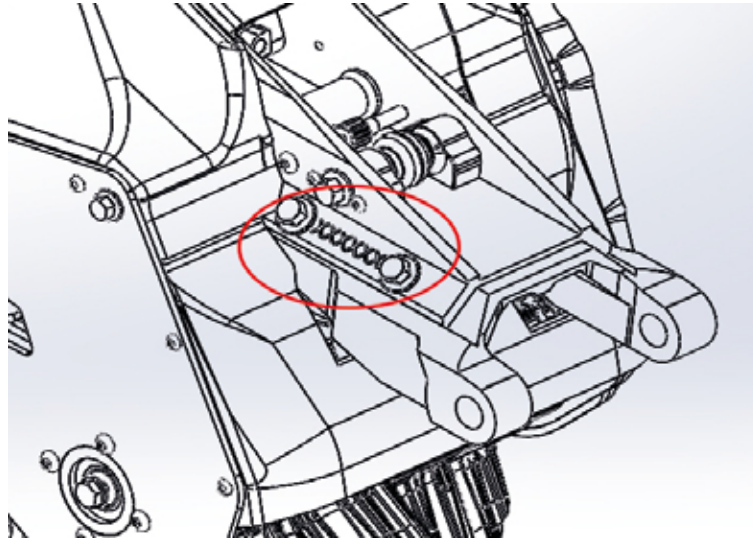

Serial number is necessary to complete warranty procedure. No warranty claim would be accepted if the serial number is deleted or intentionally distorted.

Please fill in the fields below with the relevant information about your SNOWRIDER kit. Always use this information when discussing your kit with a representative of the manufacturer.

Owner's name: _____

Model: _____

Kit serial number: _____

Date of purchase: _____

Your SNOWRIDER dealer: _____

Town: _____

PLEASE SEND ONE COPY OF THIS PAGE TO THE E-MAIL: info@snowrider.ru
In the subject of the mail put: Registration

INTRODUCTION

Congratulations! You have chosen SNOWRIDER high-quality kit, engineered and manufactured for converting an enduro/cross motorcycle into a snowbike. Each SNOWRIDER kit is an assembly intended for installation on off-road motorcycles. As the user of your SNOWRIDER, take time to familiarize yourself with the main options of the kit, maintenance and conservation instructions. Read this Manual and the attached Safety Rules before using the kit to ensure safe riding and proper use of the equipment.

Always take your ability and landscape conditions into consideration when riding. The User Manual, Safety Rules and the kit's labels use the following signs:

WARNING: 

CAUTION: 

NOTE: 

A WARNING sign highlights personal safety information. Follow these instructions at all times to avoid risk of injury or death. A CAUTION sign stands next to dangerous actions that could result in damage of the kit. Not observing these instructions may cause damage to the entire snowbike. A NOTE contains additional useful information. The User Manual includes a description of kit maintenance, instructions for assembly and use of a snowbike and recommendations on conservation of the kit out of season. If in need of service or overhaul, contact an official dealer of SNOWRIDER for professional assistance.

As of the date of publication, all data and drawings were technically accurate. Some of the Figures are only used for illustration and do not represent the actual state of the kit. The manufacturer constantly improves and modernizes its products and cannot be held responsible for minor discrepancies between the Manual and the models.

The Manual is an integral part of the kit and must be included in all resales. In case of a change of owner, contact a SNOWRIDER dealer for exact registration information. The Manual was prepared by the maintenance and warranty service departments of the manufacturer of SNOWRIDER.

The manufacturer encourages safe use of all snowbikes.

Always wear a helmet and safety glasses when riding a snowbike. Drive carefully, observe all national and local regulations and respect the rights of others. Your local SNOWRIDER dealer has information about accessories and spare parts for the kit.

WARNING

Snowbike is a quite fast-moving vehicle. As it accelerates rapidly and achieves high speeds it cannot be operated by an unskilled rider. Never take off abruptly and do not ride at high speeds when visibility is poor in an unfamiliar landscape. Observe speed limits and never attempt speeds that inhibit maneuvering and timely stopping. Before using a kit make sure to read and study the User Manual and Safety Rules. Failure to observe these precautions could lead to injury of the rider and other people.

CAUTION: Study SNOWRIDER user manual before use.



CAUTION: Study your motorcycle user manual before use with SNOWRIDER kit.

**WARRANTY CONDITIONS**

The manufacturer of the SNOWRIDER kit (hereinafter “Manufacturer”) provides warranty for every new SNOWRIDER kit, every device and accessory made or sold by the Manufacturer. The warranty extends to the first retail purchaser of the product and only to devices and accessories sold through authorized dealer of SNOWRIDER. The warranty for kits extends to the first retail purchaser of a kit, but remaining balance can be transferred to a new owner. Only products made or sold by the Manufacturer fall within the scope of the warranty. The Manufacturer makes no claim as to performance of devices by other companies when used with a SNOWRIDER kit and does not guarantee that such outside devices will not cause damage to the SNOWRIDER kit. The Manufacturer disclaims all unforeseen or consequent losses. The Manufacturer undertakes, at its discretion, to restore or replace for free (including cost of work) any parts reasonably due for replacement. These repairs must be done by an authorized SNOWRIDER dealer. No claims to improper transportation, rent or inconvenience will be paid for by the Manufacturer. A warranty event must be confirmed after an assessment of the above parts by the manufacturer or authorized SNOWRIDER dealer. The Manufacturer reserves the right to examine the parts again at its factory, if the warranty has been invoked before.

WARRANTY PERIODS

1. For kits in private recreational use: 18 months from the day of sale.
2. Warranty against splitting of the track: 12 months from the day of sale.
3. Dealer-installed accessories: 3 months from the day of sale.

LIMITATIONS OF WARRANTY:

Regular wear and abuse, including riding over terrain without sufficient snow, dirt, gravel, water or another surface not meant for snow vehicles, for the following parts:

- Replaceable ski blades

- Replaceable runners
- Damaged or deformed elements
- Brake pads
- Worn-out or torn-out chain, drive belts

WARRANTY VOID IN CASE OF THE FOLLOWING VIOLATIONS OF THE OPERATIONAL RULES:

1. Failure in natural braking process and failure in providing regular maintenance, breaking rules of conservation explained in this Manual.
2. Repair or customization by anyone other than an official SNOWRIDER dealer.
3. Accidents or abuse or negligent use of the kit.
4. Any upgrades or removal of parts, unless recommended by the Manufacturer.
5. Using the kit for racing.
6. Using the kit for commercial purposes.
7. Altering the serial number of the kit.
8. Installation of parts not sold by the Manufacturer or an official SNOWRIDER dealer or not approved by them.
9. Damage to the track from addition of ice studs.
10. Damage from improper transportation.

Without prejudice to the foregoing, any warranty claim is valid only under the terms and within the warranty periods outlined above. This warranty gives you legal rights that may vary with your national legislation. Some legislations do not accept limitations of warranties, in which case the limitations above may not apply to you.

Spare parts and accessories

When parts from your kit or accessories have to be replaced, make sure to use only ORIGINAL SNOWRIDER parts. Only original parts are designed to meet completely the standards and requirements of your SNOWRIDER kit. Contact an official SNOWRIDER dealer for the full list of spare parts.

First ride, belt run-in

1. Prior to use of Snowrider kit WENDIGO, and also while changing out gearbox belt, it is necessary to perform trial run-in.

- The first ride must not last more than one engine hour, do not exceed 50% of the snowbike power
- After the first hour of operation check the belt tension, perform belt tension adjustment (see. item 3).
 - The second ride is not time restricted, to complete run-in procedure try not exceed 75% of the snowbike power.
 - Check belt tension after the second ride, make visual inspection of the gearbox case against foreign particles, blow with compressed air if necessary.
 - Belt run-in is completed, further operation of the kit does not require any special service on belt.
 - Perform regular gearbox inspection at least after every 15 engine hours
 - All kinds of gearbox maintenance must be performed in the warm indoor area by the temperature of 15C°-25C° while absence of icings of Snowrider kit parts.

Procedure on setup and adjustment of drive belt tension for your WENDIGO kit is described under item 2 of the current chapter.



Belt tension degree is configured according to the item 3.

IMPORTANT: Operation of the Snowrider kit WENDIGO with dismantled gearbox housing is prohibited!



2. Procedure on setup and adjustment of drive belt tension for your WENDIGO kit. Unscrew bolts (1) and remove gearbox housing (2) (Pic. 1). For installation/removal of belt loosen bolt of belt tensioner (1) and tensioner screw retainer (3), turn adjusting screw of tensioner (4) counter-clockwise (screw is located inside of the tunnel) until: belt (2) is able to be freely set on sheaves /removed from sheaves (Pic. 2). Turn adjusting tensioner screw (4) clockwise to achieve such preliminary tension where the belt (2) is tightly set on sheaves without visible slack. For the fine adjustment of the belt tension degree follow the recommendations given in item 3 of the current chapter. Upon completion of belt tensioning tighten tensioner screw retainer (3) and bolt of belt tensioner (1) (Pic. 2). Install gearbox housing (2) and make up bolts (1) (Pic. 1).

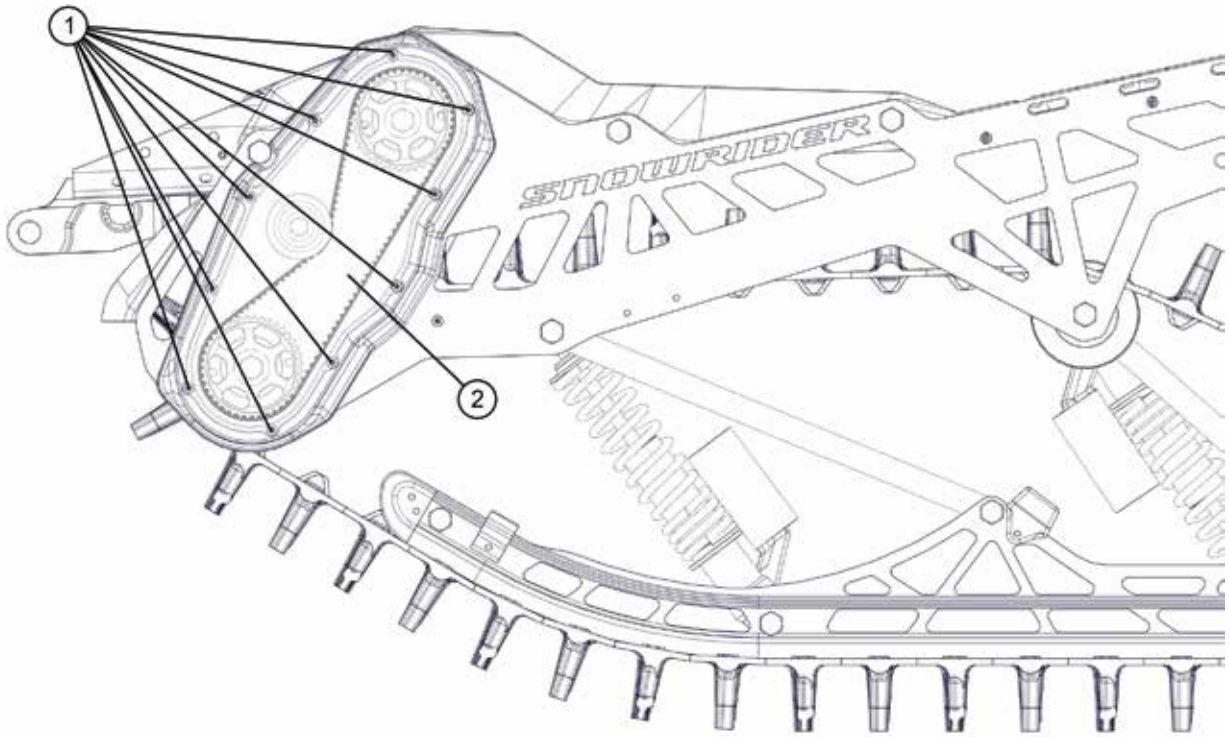

Pic.1

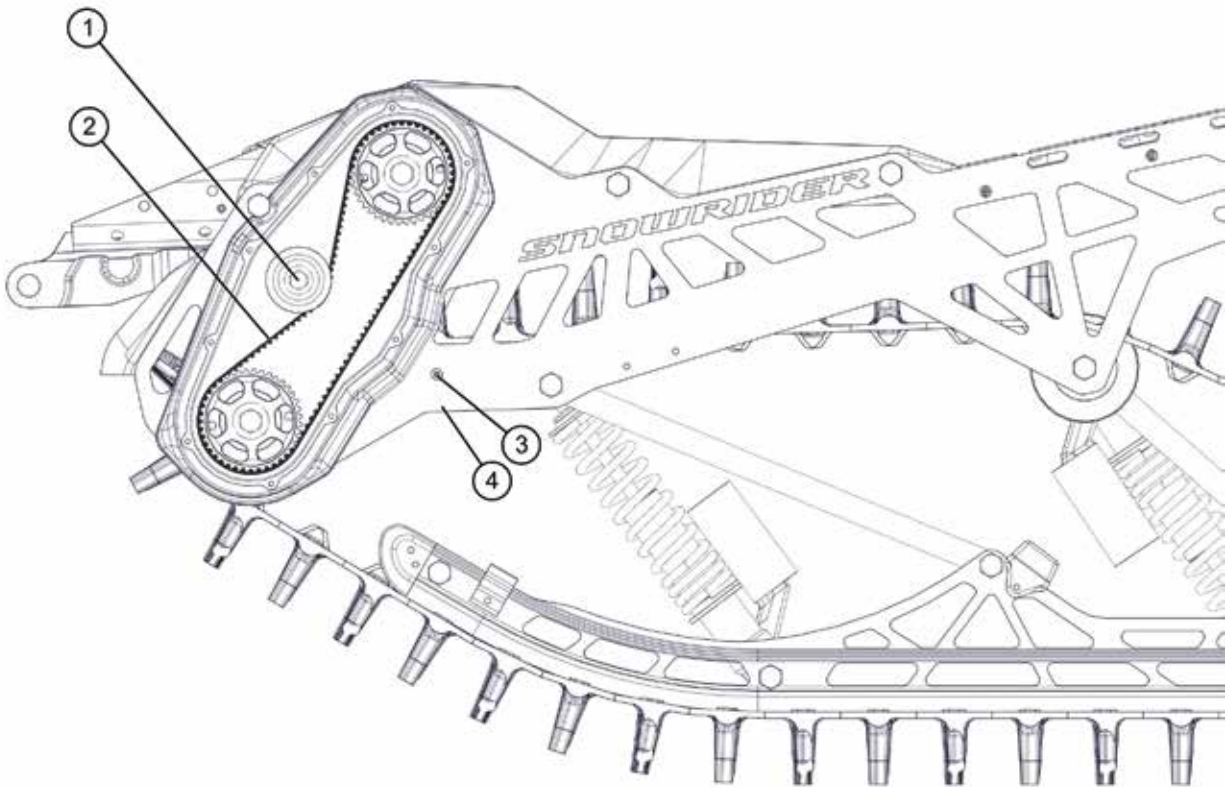

Pic.2

3. For fine adjustment of WENDIGO belt tension you will have to setup and run MySNOWRIDER application on your smartphone. It is necessary to remove gearbox housing. Place your phone microphone close to the gearbox housing as shown on Pic. 3 or to another position, that will ensure reliable transmission of sound oscillations from gearbox housing to the phone body. Pull the belt by finger and sudden release it. Control application readings. In order to adjust tension loosen tensioner bolt (1) by 1/4 turn, loosen tensioner screw retainer (3) (Pic.2).
- In case, tensiometer pointer is located at «low» sector, you will have to increase tension of the belt (2) by turning adjusting screw (4) clockwise. For tension check using the phone application tighten the tensioner bolt (1) to the full, but not torque up.
 - In case, tensiometer pointer is located at «high» sector, you will need to decrease tension of the belt (2) by turning adjusting screw (4) counter clockwise. For tension check using the phone application tighten the tensioner bolt (1) to the full, but not torque up.
 - Make sure, that by pulling back and sudden release of the belt, tensiometer pointer in application is located at the middle of green zone.
 - Upon completion of adjustment torque up tensioner bolt (1) with torque 40 Nm, tighten adjusting screw retainer, install back the gearbox housing, make up housing bolts.

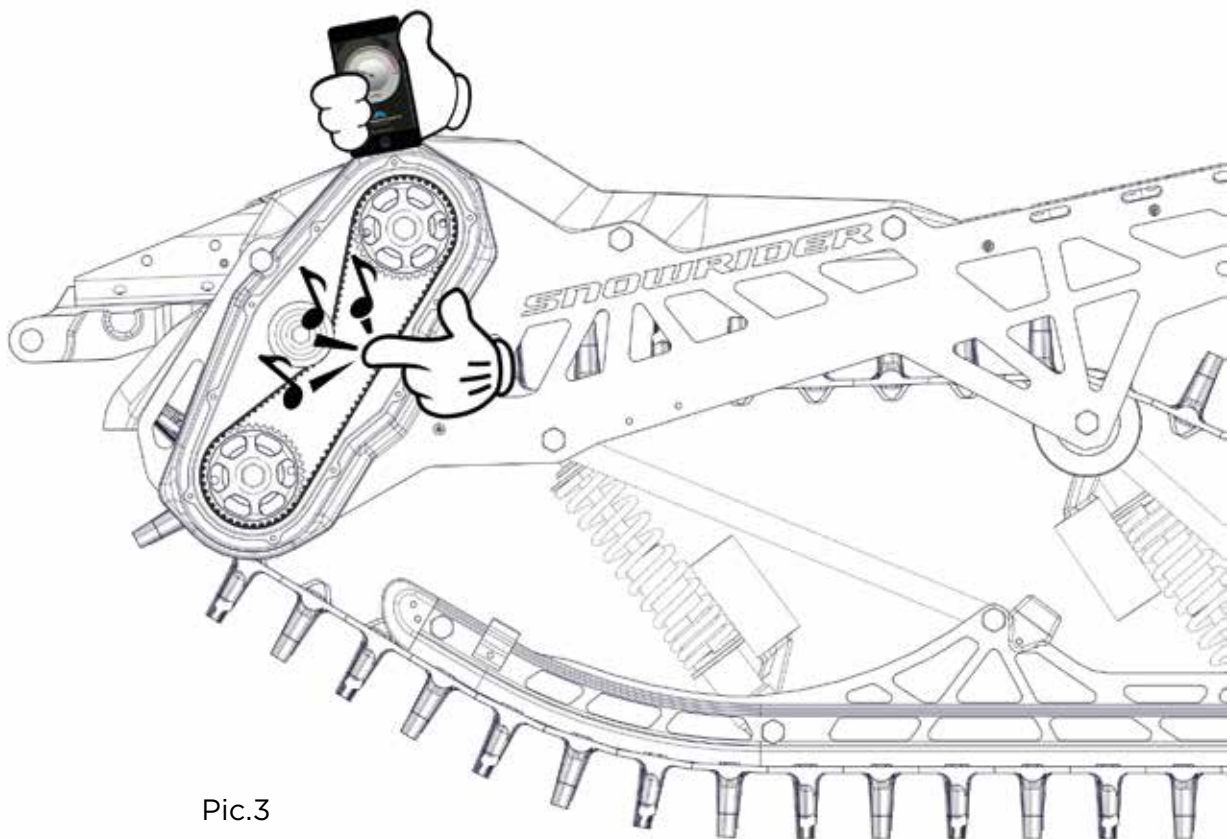

Pic.3

SAFETY INSTRUCTION FOR SNOWRIDER KIT

1. Introduction
2. Maintenance of technical condition
3. Providing rider safety
4. Kit operating conditions
5. Climatic conditions
6. Rules of operation on various terrain

1. Introduction.

The SNOWRIDER kit is designated for installation on a modern single-seat lightweight motorcycle of cross/enduro class with a left-hand drive chain and an engine size of 250 cm³. In addition to this manual, you should fully study the instructions for the motorcycle with which you will operate the SNOWRIDER conversion kit. Failure to follow the instructions may result in serious injury or death.

WARNING: The SNOWRIDER conversion kit is designed to be mounted only on a single-seat motorcycle and can only be used by one rider. 

CAUTION: Read the User Manual for the SNOWRIDER conversion kit before use. 
CAUTION: Read the User Manual for your motorcycle before use with the SNOWRIDER conversion kit.

2. Technical maintenance of the SNOWRIDER conversion kit

To protect yourself and others you need to keep your equipment in good technical condition. To do this, refer to the maintenance and servicing section of this Manual. The same is true for your motorcycle.

WARNING: Do not use a damaged or incomplete SNOWRIDER conversion kit. 

WARNING: For your safety, it is prohibited to make any changes to the design of the equipment. 

WARNING: Do not use the kit on a broken motorcycle. 

RECOMMENDATION: The installation of the conversion kit on a motorcycle should be entrusted to a certified authorized service center. 

RECOMMENDATION: For maintenance, repair, and replacement of parts, contact a certified authorized service center. 

3. User Safety

Before using the SNOWRIDER conversion kit, study the rules of its operation, as well as information and warning labels located on the kit itself. Before each departure inspect both the SNOWRIDER conversion kit and the motorcycle. The description of the inspection procedure for the SNOWRIDER conversion kit is set out in the relevant section of this manual, and the description of the technical inspection procedure for your motorcycle is provided in its User Manual.

Before starting the engine, make sure that all protective covers of the mechanisms are in place,

the brakes are working, the gearbox of the motorcycle is set to neutral.

The engine starts only when the brake is on. Starting the engine in an unventilated area, as well as unsupervised starting, are strictly prohibited.

An open drive chain between the sprocket of the motorcycle and the intermediate shaft of the track module is a potential source of danger.

WARNING: Do not allow foreign objects to enter the chain and the chain track while driving.

WARNING: Do not wear too loose clothes, long scarves and other accessories (suspenders, belts, ties, etc.) that may fall into the moving parts of the snowbike and lead to tragic consequences. 

WARNING: Do not drink alcohol or drugs before and during use. The state of alcoholic or drugs intoxication significantly impairs the reaction rate and the adequacy of perception of the environment which can lead to serious injuries or death.

WARNING: Refrain from traveling if you feel unwell, sick, or injured.

CAUTION: Always wear a certified helmet, eye protection, and face protection. Use only the equipment that does not block view and does not hinder movement. Also, your clothes should match the ambient temperature. 

CAUTION: To avoid injury, use special protective equipment: for snowbike or cross-country.

Regardless of the experience of driving a motorcycle or a snowbike, anyone riding a snowbike for the first time is a novice. Before riding to an open area, the manufacturer recommends to train with snowbike on a flat area at a low speed until you get used to control it.

Do not get distracted while riding a snowbike. Fences or other objects hidden by snow can pose a serious threat. When detouring telephone poles and power line poles, leave more free space: hidden wires that are invisible at a distance can cause serious accidents.

In the event of an emergency, press the engine emergency stop button and apply the brakes. Remember, the tricks you saw in the promotional materials were performed by professional riders in ideal and / or controlled conditions. Do not try to repeat them.

4. Snowrider Kit Operating Conditions

The snowbike is intended for use only on snow cover outside populated settlements and public roads, or on specially prepared and fenced sites. It is possible to cross roads with all possible precautions: along the shortest route, with good visibility, with an obligatory stop and inspection on the sides before the maneuver. In case of emergency, it is permissible to ride on the side of the road at a low speed, without interfering with vehicles.

The height of the snow cover should be sufficient to lubricate the kit track.

WARNING: Continuous movement without lubrication with snow is prohibited.

WARNING: The SNOWRIDER kit is not designed for jumping and performing tricks. 

CAUTION: The SNOWRIDER kit is intended for use only on the snow. 

Before going on frozen ponds, make sure that the ice is sufficiently thick, there is no ice hole and icebuild-ups. Remember that ignoring this rule can cost you your life.

Move on the ice with extreme caution: an attempt to turn sharply or brake on a slippery surface can lead to uncontrolled rotation and fall. Sudden braking, riding with excessive speed and sharp turns on the surface covered with an ice crust are strictly prohibited. If you have to ride on such surfaces, slow down. The user assumes all the risks associated with movement over frozen water bodies.

Riding through water obstacles is strictly prohibited, it can lead to tragic consequences.

Movement at night on a snowbike which is not equipped with lighting equipment is prohibited.

Snowbike is not designed for towing people or vehicles. Towing a snowbike is also unacceptable.

WARNING: Do not tow equipment or people.

The snowbike is equipped with a tunnel shelf, which can be used for transportation of fuel and / or equipment. The shelf is not intended for transporting people or animals, as well as goods over 20 kg.

WARNING: Do not carry people or animals on the top of the tunnel.

CAUTION: Maximum distributed load on the tunnel cover is 20 kg.



In addition, the tunnel shelf serves to protect the operator from snow and other objects such as rocks, ice fragments and debris flying out from under the track.

WARNING: Do not use with a removed, poorly fixed or damaged shelf (cover) of the tunnel.

WARNING: Staying behind or near a rotating track is strictly prohibited.



CAUTION: Remember that during the movement objects that are dangerous to life and health of others can fly out from under the track.



Single rides away from civilization can be dangerous. Fuel may run out, vehicle breakdowns or accidents may occur. Remember that the distance a snowbike can cover in one hour cannot be covered by a human in one day. Always go for long distances with a partner or group. Always notify rescue services, relatives or friends about your route and the time of your expected return.

RECOMMENDATION: Always take with you a reserve of fuel and oil.

RECOMMENDATION: Always take with you the means of communication.

RECOMMENDATION: Always take the minimum required tools with you.

RECOMMENDATION: Always take first aid supplies with you.

RECOMMENDATION: When going on long-term trips always take a winter survival kit.

RECOMMENDATION: During a long trip, notify the rescue services, relatives or friends about your route and the time of the expected return.



When traveling with a group, remember not to try to impress the other riders and overtake them. A less experienced rider may try to repeat this after you and fail. When riding in a group, limit your riding skills according to the experience of the other riders.

When moving in a group, avoid sudden accelerations. Snow and ice can be thrown out from under the track at the riders behind you.

Avoid moving too closely behind the rider ahead of you. In case, if by some reason s/he slows down, you may run into him/her. Maintain a sufficient distance for safe braking between you and the rider ahead. Depending on the terrain conditions, you may need a greater distance for braking than you think. Do not take risks. Be ready for a dodging maneuver.

Familiarize yourself with the local legislation governing the use of snowmobiles/snowbikes and moto-cross equipment.

5. Climatic conditions

The SNOWRIDER kit is designed for use in the temperature range from +15 to -20 degrees Celsius, this temperature range is primarily due to the safety of the user.

Remember that in the wind or when moving the cold can feel much worse. See the Table representing the sensible temperature corresponding to the wind speed.

		WIND CHILL CHART									
		Ambient Temperature (°C)									
		4	-1	-7	-12	-18	-23	-29	-34	-40	
Wind km/h	Velocity mph	Equivalent Chill Temperature (°C)									
Calm											
0	0	4	-1	-7	-12	-18	-23	-29	-34	-40	
8	5	3	-3	-9	-14	-21	-26	-32	-38	-44	
16	10	-2	-9	-16	-23	-30	-35	-43	-50	-57	
24	15	-6	-13	-20	-28	-36	-43	-50	-58	-65	
32	20	-8	-16	-23	-32	-39	-47	-55	-63	-71	
40	25	-9	-18	-26	-34	-42	-51	-59	-67	-76	
48	30	-16	-19	-22	-36	-44	-53	-62	-70	-78	
56	35	-11	-20	-29	-37	-46	-55	-63	-72	-81	
64	40	-12	-21	-29	-38	-47	-56	-65	-73	-82	

Adapted from: Threshold Limit Values (TLV™) and Biological Exposure Indices (BEI™) booklet; published by ACGIH, Cincinnati, Ohio

Little danger – in less than one hour exposure of dry skin
Maximum danger of false sense of security

DANGER – Exposed flesh freezes within one minute

GREAT DANGER – Flesh may freeze within 30 seconds

Low air temperatures have an adverse effect on the human body and well-being. Hypothermia can cause severe weakness, drowsiness, reduce attention and speed of reaction. The risk of frostbite in the open air at low temperatures (especially with the wind) is very great because the cold acts slowly, painlessly and during the ride you may not feel frostbite. Always learn the upcoming weather forecast to select appropriate clothing and equipment. Refrain from traveling in case of severe frosts, high wind speeds or heavy rainfall. With deterioration of visibility caused by precipitation, it is recommended to reduce the speed. For group travel, also increase the distance between the riders. When visibility is below 25 meters, the movement should stop; stop and wait on the weather to improve.

6. Rules of Operation on Various Terrains

Prepared tracks

When riding on specially prepared snow tracks or tightly packed snow, the snowbike is able to develop maximum speed. Slow down before turning and shift the center of gravity inward. Be careful: falls at high speeds are dangerous. When riding in groups, keep other riders in sight, think in advance about possible maneuvering options, be ready to start them at any time.

CAUTION: Falling on thick snow is equivalent to falling on the asphalt.



Deep snow

When riding in deep loose snow, avoid sudden opening of the throttle and sudden braking; this can lead to the burying and stopping of the snowbike.

If the snowbike stopped in deep snow and is not able to continue moving, clean the ski, the track and the tunnel from snow and ice and trample the snow in front of the ski and track. Carefully working the clutch and throttle, bring the snowbike onto a hard surface, then continue riding.

Forest and rugged terrain

Use extreme caution when riding through woods and rough terrain. Choose a speed with the expectation that you would have time to react to the obstacles hidden by the folds of the relief (ravines, holes, streams), trees or thickets. Remember that stumps, logs, stones and other dangerous items can hide under the snow.

When climbing steep slopes, move the center of gravity forward. Immediately upon reaching the top, relieve the speed, since you do not have the opportunity to assess the situation behind the slope or at its top. If you don't get on the slope "head-on" or the speed on the ascent begins to fall

- turn the snowbike to the side and continue moving along the slope diagonally. When descending, move the center of gravity back. Try to use engine braking or brake operation in intermittent mode. To prevent tipping over the steering wheel on steep slopes, climb down diagonally.

When riding in groups, keep a safe speed and distance between the riders.

Mountain slopes

When using a snowbike in a mountainous area, avalanches are one of the most serious dangers. Always learn about the category of avalanche danger of the region you are going to, keep to the permitted tracks, and use the services of experienced guides.

WARNING: An avalanche can come down from any slope, at any time, under any conditions. Do not ride on avalanche slopes.

CAUTION: Use special equipment when riding on mountain slopes.



To minimize the risks, take an avalanche safety course. Bring special equipment with you:

- Avalanche search beacon with new batteries
- Probe
- Backpack
- Portable spade
- First Aid Kit
- Means of communication
- Survival kit for winter conditions

Observe the following rules:

- Wear multi-layered clothing: this will help protect against hypothermia.
- Choose bright colors for your clothes to be noticeable in the snow.
- Always keep the essentials in your backpack. Secondary things can be kept in the snowbike
- Read instructions and user manuals for all your gear.
- Get practical skills in using emergency equipment
- Learn about the weather and snow conditions before you go.
- Do not go to the mountains alone
- Cross hazardous areas strictly one by one

GENERAL SNOWBIKE RIDING SAFETY RULES

- Do not drink and drive
- Always wear a helmet
- Stay away from thin ice and beware of cracks
- Be alert when crossing highways
- Do not use the snowbike at night
- Avoid obstacles
- Do not tow cargo or other vehicles
- A snowbike is a single-passenger vehicle
- Attend to maintenance regularly
- Only adults may drive
- Study carefully the User Manual
- Observe the traffic code and limitations as they relate to snow vehicles

Brief maintenance procedure

№	Component	Periods					
		100 km (3 m/h)	500 km (10 m/h)	1000 km (20 m/h)	5000 km (100 m/h)	Before conservat ion	After conserva tion
	Ski spacer	I	I	I	I	I	I
	Blades	I	I	I	I	I	I
	Drive chain	I	I	I	I	I,L	I,L,T
	Sprocket of drive chain	I	I	I	I	I,L	I
	Chain tensioner slider	I	I	I	I	I	I,T
	Gearbox belt	I	I	I	I	I,L	I,L,T
	Gearbox sprockets	I	I	I	I	I,L	I,L
	Gearbox belt tensioner	I	I	I	I	I	I,T
	Track module	I	I	I	I	I,L,T	I,L,T
	Sliders	I	I	I	I	I	I
	Rails	I	I	I	I	I	I
	Rear wheels	I	I	I	I	I	I
	Upper rollers	I	I	I	I	I	I
	Drive shaft	I	I	I	I	I	I
	Drive shaft bearings	I	I	I	I	I	I
	Intermediate shaft	I	I	I	I	I	I
	Bearings of intermediate shaft	I	I	I	I	I	I
	Arm bushings	I	I	I	I	I	I
	Shock absorbers	I	I	I	I	I	I
	Stoppers	I	I	I	I	I	I
	Brake caliper	I	I	I	I	I	I
	Brake fluid	I	I	I	I	I	I
	Brake pads	I	I	I	I	I	I
	Brake disc	I	I	I	I	I	I
	Brake hydraulic line	I	I	I	I	I	I
	Fixations of the kit	I	I	I	I	I	I
I – Visual inspection (adjustment, cleaning, greasing, replacement – if needed)							
T – Adjustment							
L – Cleaning, greasing							
R – Replacement							

PREPARATION FOR CONSERVATION

Before putting the kit in conservation a maintenance check-up is needed to avoid corrosion and degeneration of the parts. This service is performed by official SNOWRIDER dealer, however the owner can do this himself. Such a service is held at the wish and expense of the kit's owner.

To prepare the kit for conservation please carry out the following actions:

1. Detach the kit from the motorcycle, if they are to be stored separately. For removal refer to the Installation manual of the SNOWRIDER Kit.
2. Thoroughly clean the kit of dirt, oil, grass and other filth. Leave the kit to dry until all moisture has evaporated from all of the elements.
3. Put lubricant on the bolts and bushings of the front and rear parts of the kit.
4. Examine the condition and functionality of the moving parts, if necessary, replace worn-out ball bearings and bushings.
5. Tighten all nuts, bolts and screws and make sure they are tightened securely. Make sure that all rivets and retaining components are tight. Replace weak rivets.
6. Clean and polish the kit, including the ski, its spindle, frame, tunnel, runners, track module. For better preservation of rubber and plastic parts, put silicon spray lubricant over them.
7. If possible, store the kit indoors. Loosen the retaining bolts of the track to relieve tension. Put a car holster or a piece of tarpaulin over the kit to protect it against dust and dirt.
8. If the kit is to be kept outdoors, keep it away from direct sunlight. Loosen the retaining bolts of the track to relieve tension. Put a car holster or a piece of tarpaulin over the kit to protect it against dust and dirt.

WARNING



Do not keep the kit under direct sunlight and under a plastic cover, as it will lead to accumulation of moisture and corrosion. Do not store the kit in the vicinity of heating devices and in direct sunlight to avoid warping. The ski should be kept on two rectangular wooden blocks and without excessive load down on it.

DECONSERVATION

Thorough preparation of the kit to a new riding season after extended conservation ensures long and trouble-free operation. The manufacturer recommends:

1. Carefully clean the kit and its parts and elements.
2. Check the operational condition and adjustments of suspension as well as integrity of the equipment and its parts.
3. Tension all nuts, bolts and screws and check that they are tightened securely.
4. Examine the tension of the gearbox chain and belt, adjust if necessary.
5. Examine the brake system, ski blades, runners, condition of the bearings and moveable parts, spindle of the ski and track module, replace worn-out parts if necessary.
6. Adjust the track to normal tension and tighten the nuts.

OWNER RESPONSIBILITY

Owners of SNOWRIDER kits are responsible for correct maintenance and use of their kits as described in this User Manual. Correct maintenance includes timely technical inspections, as the Manual sets out. Owners are also responsible for proper and as-intended application of the kits.

CHANGES OF OWNER ADDRESS, CHANGES OF OWNERSHIP AND TRANSFERS OF REMAINING WARRANTY TIME

The manufacturer retains and registers in its database information about the owner and his address. This is done to provide the owner in a timely manner with important information on safety measures which could be undertaken to protect the user from injury to himself and property.

If you have changed your place of residence, please contact an official SNOWRIDER dealer and request that the manufacturer be informed.

If the kit passes to a new owner, you should likewise let the manufacturer know through a dealer. The form below, sent to a dealer, can also be used to transfer remaining warranty time to another owner.

Please fill out this card and deliver it to your nearest official SNOWRIDER dealer.

A dealer must pass this card to the manufacturer for the following changes:

- Change of residence
- Change of ownership
- Transfer of remaining warranty time

CHANGE OF RESIDENCE/OWNERSHIP/WARRANTY TRANSFER

Name _____
Address _____
Town/Region _____
Postal code _____
Phone _____
Production year and kit model _____
SNOWRIDER Kit serial number _____

MAKING A WARRANTY CLAIM/ OWNER RESPONSIBILITIES

By the time a sale of the kit is concluded, a registration card with owner information must be filled out by the buyer and dealer. The warranty period begins only if the manufacturer has received the registration card. Dealers are responsible for sending the cards to the manufacturer after sales without delay.

The dealer must return to the buyer a signed copy of the registration card, to be passed to the dealer along with a warranty repair request. The registration card is proof of ownership and that the warranty period has begun. Make a copy and keep it in a safe place.

When warranty repair is needed, take your kit to the dealer that sold it to you and is responsible for warranty service. If that dealer refuses warranty service, if you have move or are far away, you can contact any official SNOWRIDER dealer.

The dealer will examine the kit and if the problem is a warranty-covered event, will perform fault determination to discover which parts must be replaced. The dealer will then repair or replace all damaged elements, both the parts and the work free of charge. You will have to sign a Free Warranty Repair Act to document the fact.

The owner's responsibilities include maintenance of the kit according to the recommendations of this Manual. For your own safety and to preserve your kit, follow all safety rules. The manufacturer will not perform warranty repair if the cause of the fault is nonperformance of maintenance or the recommended conservation procedure.

Contact an official SNOWRIDER dealer with any questions about the warranty.



SNOWRIDER



Alpha Drive Ltd.
Respubliki St., bld. 249/4 Tyumen 625014, Russia
Tel: +7 (3452) 500-158
e-mail: info@snowrider.ru
www.snowrider.ru